

4mm - 9mm I/D hose  
1/8" - 1/4" BSP thread

- Low pressure drop across coupling
- High flow rate
- Compact construction
- One hand operation
- Robust construction
- Various connection variables



## Technical Data

Medium:

Compressed air

Operating Temperature:

-20°C to 100°C

Working Pressure:

0 - 35 bar

Interchangeability:

Rectus 21

Rectus 90

Camozzi

## Materials

Coupling body	- Brass nickel plated
Sleeve	- Red anodised aluminium
Valve	- Brass
Springs	- Stainless steel AISI 301
Balls	- Stainless steel AISI 420
Seals	- Buna N (Nitrile)
Plugs	- Nickel plated brass

## Ordering Information

To order, quote appropriate product number from the tables on the following pages.



Coupling with one side shut-off  
& plug without shut-off





## Single Shut-Off Couplings

Socket Male thread

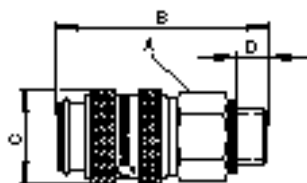

Product number	Connection	A A/F	B	C	D
233210018	G $\frac{1}{8}$	14	36	16,5	7
233210028	G $\frac{1}{4}$	17	38	16,5	9

## Single Shut-Off Couplings

Socket Female thread

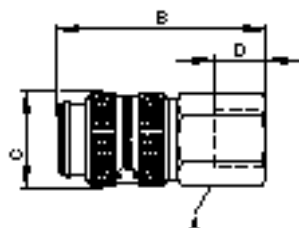

Product number	Connection	A A/F	B	C	D
233220018	G $\frac{1}{8}$	14	36	16,5	9
233220028	G $\frac{1}{4}$	17	38	16,5	9

## Single Shut-Off Couplings

Socket Hose Barb

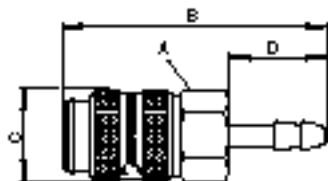

Product number	Connection for hose I/D	A A/F	B	C	D
233230400	4	14	46	16,5	17
233230600	6	14	46	16,5	17
233230900	9	14	46	16,5	17

## Single Shut-Off Couplings

Socket Push-on Fitting

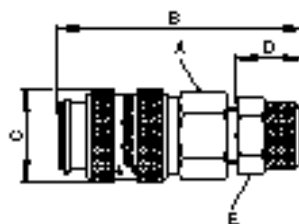

Product number	Connection for hose O/D I/D	A A/F	B	C	D	E A/F
233260400	6/4	14	42	16,15	11	12
233260600	8/6	14	42	16,15	11	14

## Single Shut-Off Couplings

Socket Push-on Fitting Panel Mounted

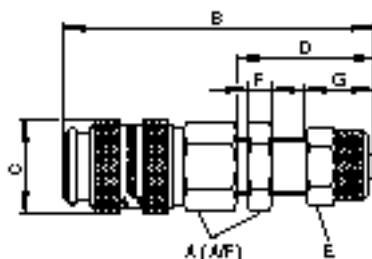

Product number	Connection for hose O/D I/D	A A/F	B	C	D	E A/F	F	G
233280400	6/4	14	54	16,15	25	12	4	11
233280600	8/6	17	54	16,15	25	14	4	11

## Single Shut-Off Couplings

Socket with Spring Guard

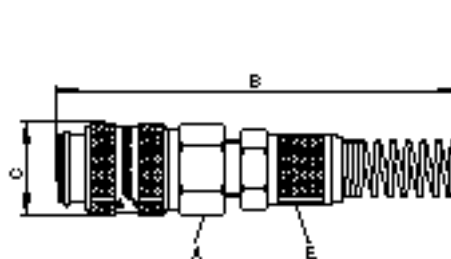

Product number	Connection for hose O/D I/D	A A/F	B	C	E A/F
233290400	6/4	14	125	16,15	12
233090600	8/6	14	132	16,15	14



## Single Shut-Off Couplings

## Plug Male Thread

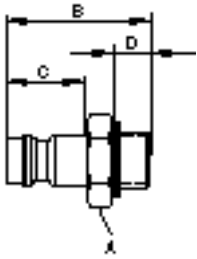

Product number	Connection	A A/F	B	C	D
233110018	G $\frac{1}{8}$	14	25	14	7
233110028	G $\frac{1}{4}$	17	27,5	14	9

## Single Shut-Off Couplings

## Plug Female Thread

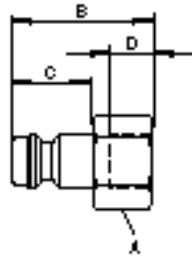

Product number	Connection	A A/F	B	C	D
233120018	G $\frac{1}{8}$	14	24,5	14	8
233120028	G $\frac{1}{4}$	17	25	14	9

## Single Shut-Off Couplings

## Plug Hose Barb

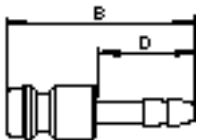

Product number	Connection hose bore	B	D
233130400	4	32	17
233130600	6	32	17
233130900	9	33	17

## Single Shut-Off Couplings

## Plug Push-on Fitting

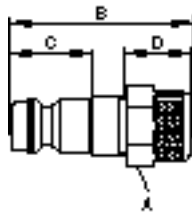

Product number	Connection for hose O/D I/D	A A/F	B	C	E A/F
233160400	6/4	12	31,5	14	11
233160600	8/6	14	31,5	14	11

## Single Shut-Off Couplings

## Plug with Spring Guard

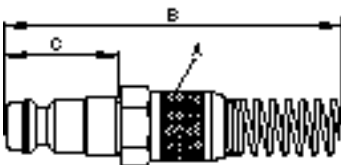

Product number	Connection for hose O/D I/D	A A/F	B	C
233190400	6/4	12	113	14
233190600	8/6	14	123	14

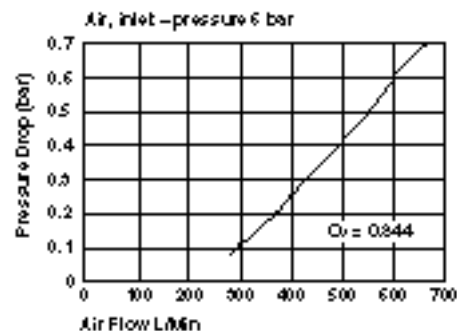

## Warning

These products are intended for use in industrial compressed air systems only. Do not use these products where *pressures* and *temperatures* can exceed those listed under 'Technical Data'.

Before using these products with fluids other than those specified, for non-industrial applications, life-support systems, or other applications not within published specifications, consult Norgren.

Through misuse, age, or malfunction, components used in fluid power systems can fail in various modes. The system designer is warned to consider the failure modes of all component parts used in fluid power systems and to provide adequate safeguards to prevent personal injury or damage to equipment in the event of such failure.

System designers must provide a warning to end users in the system instructional manual if protection against a failure mode cannot be adequately provided.

System designers and end users are cautioned to review specific warnings found in instruction sheets packed and shipped with these products where applicable.

- Low pressure drop across coupling
- High flow rate
- One hand operation
- Robust construction
- Various connection variables



## Technical Data

Medium:

Compressed air

Operating Temperature:

-20°C to 100°C

Working Pressure:

0 - 35 bar

Interchangeability:

Cejn 320

## Materials

Coupling body	- Brass nickel plated
Sleeve	- Steel, hardened and nickel plated
Valve	- Brass
Springs	- Stainless steel AISI 301
Balls	- Stainless steel AISI 420
Seals	- Buna N (Nitrile)
Plugs	- Steel hardened and nickel plated

## Ordering Information

To order, quote appropriate product number from the tables on the following pages.

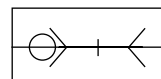

Coupling with one side shut-off  
& plug without shut-off

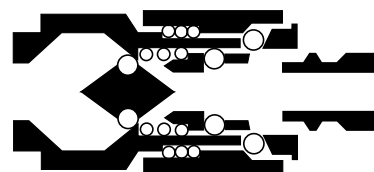



## Single Shut-Off Couplings

Socket Male thread

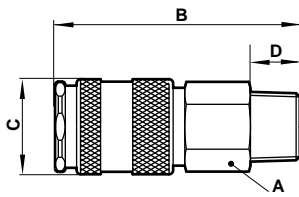

Product number	Connection	A A/F	B	C	D
234210028	R <sup>1</sup> / <sub>4</sub>	19	60	23	12
234210038	R <sup>3</sup> / <sub>8</sub>	19	60	23	13
234210048	R <sup>1</sup> / <sub>2</sub>	22	65	23	17

## Single Shut-Off Couplings

Socket Female thread

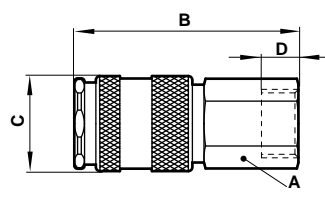

Product number	Connection	A A/F	B	C	D
234220028	G <sup>1</sup> / <sub>4</sub>	19	55	23	9
234220038	G <sup>3</sup> / <sub>8</sub>	19	55	23	9
234220048	G <sup>1</sup> / <sub>2</sub>	24	57	23	12

## Single Shut-Off Couplings

Socket Hose Barb

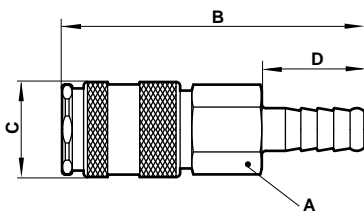

Product number	Connection hose bore	A A/F	B	C	D
234230600	6	19	73	23	25
234230900	9	19	73	23	25
234231300	13	19	73	23	25

## Single Shut-Off Couplings

Plug Male Thread

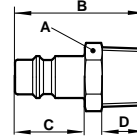

Product number	Connection	A A/F	B	C	D
234110018	R <sup>1</sup> / <sub>8</sub>	13	33	20	9
234110028	R <sup>1</sup> / <sub>4</sub>	14	37	20	12
234110038	R <sup>3</sup> / <sub>8</sub>	17	37	20	12
234110048	R <sup>1</sup> / <sub>2</sub>	22	43	20	17

## Single Shut-Off Couplings

Plug Female Thread

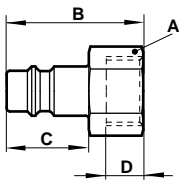

Product number	Connection	A A/F	B	C	D
234120028	G <sup>1</sup> / <sub>4</sub>	17	33	20	9
234120038	G <sup>3</sup> / <sub>8</sub>	19	33	20	9
234120048	G <sup>1</sup> / <sub>2</sub>	24	36	20	12

## Single Shut-Off Couplings

Plug Hose Connection

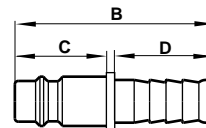

Product number	Connection hose bore	B	C	D
234130600	6	48	20	25
234130900	9	48	20	25
234131300	13	48	20	25

## Pressure Drop (bar)

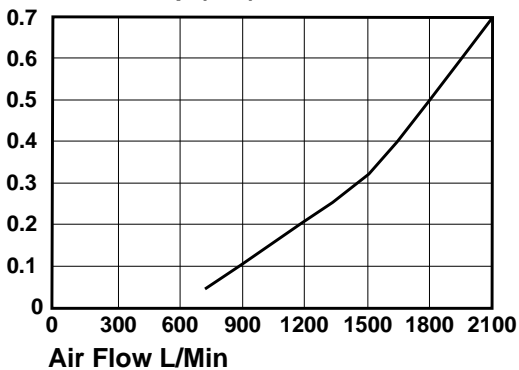

Air, inlet-pressure 6 bar  
Cv = 2.764

## Warning

These products are intended for use in industrial compressed air systems only. Do not use these products where *pressures* and *temperatures* can exceed those listed under 'Technical Data'. Before using these products with fluids other than those specified, for non-industrial applications, life-support systems, or other applications not within published specifications, consult Norgren. Through misuse, age, or malfunction, components used in fluid power systems can fail in various modes. The system designer is warned to consider the failure modes of all component parts used in fluid power systems and to provide adequate safeguards to prevent personal injury or damage to equipment in the event of such failure. **System designers must provide a warning to end users in the system instructional manual if protection against a failure mode cannot be adequately provided.** System designers and end users are cautioned to review specific warnings found in instruction sheets packed and shipped with these products where applicable.